

GSD

1705-2-1

REVISIONS	
ISSUE	CHANGES
2	CN 17012 E KH 10/17/94
D	REVISED PER ER19059 GGR 10/085/2009

KAM3981

THIS DRAWING, THE DESIGNS AND IDEAS EMBODIED IN THE DEVICE TO WHICH IT RELATES, AND THE METHOD OF PRODUCING THE DEVICE, ARE THE PROPERTY OF WINCHESTER ELECTRONICS CORPORATION AND SHALL NOT BE EMPLOYED, COPIED, OR DISCLOSED TO ANYONE, IN ANY MANNER WITHOUT THE CONSENT OF WINCHESTER ELECTRONICS CORPORATION.

SCALE 4:1

APPROX SURFACE AREA

USED ON

REF:

PLUG, SHV

DRAWN KH DATE 10/17/94

DESIGN MJB DATE 10/18/94

APPR. DATE

Winchester Electronics
62 Barnes Industrial
Road North
Wallingford, CT 06492

1705-2-1

GSD

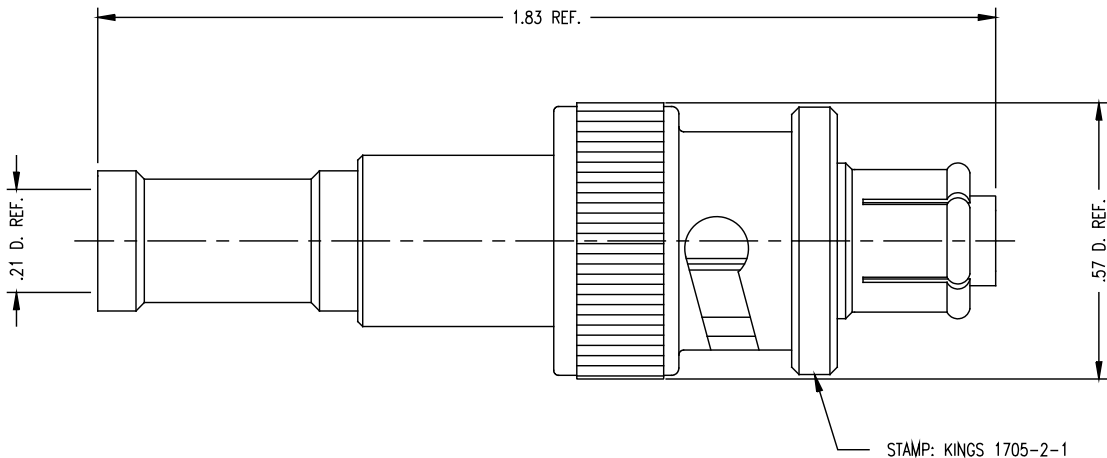

NOTES:

- FOR USE WITH RG-58, 58A, 58C, 141 & 141A/U CABLES.
- FOR CABLING INSTRUCTIONS SEE CP-441.
- FOR CRIMPING USE DIE KTH-2061.
- FOR CABLE TRIMMING USE KTJ-72 & KTD-136.
- INTERFACE PER MIL-STD-348, FIG. 314-2.
- MATERIALS:
INSULATOR: REXOLITE, L-P-516
GASKET: SIL. RUB., ZZ-R-765
K-GRIP SLEEVE: COMMERCIAL BRONZE TUBE, ALLOY 220
SPRING WASHER & CONTACTS: BER. COP., ASTM-B-196
ALL OTHER PARTS: BRASS, ASTM-B16
- FINISHES:
CENTER CONTACT: HARD GOLD PLT. PER MIL-G-45204
SPRING WASHER: SILVER PLATE PER QQ-S-365
ALL OTHER METAL PARTS: KINGS TARNISH RESISTANT NICKEL FINISH (TR-5)
- ELECTRICAL CHARACTERISTICS:
OPERATING VOLTAGE: 3500 VOLTS AC
5000 VOLTS DC