

Rack & Panel

JF Series

Miniature Side Mount / #20 Contacts / .040" Dia. / 7.5 Amps

OUTLINE

Dimensions are for reference only and are subject to change. Outline drawings on request.

Side Mounting, 4 Position Rectangular 2 and 4 Position In-Line

JF Series, PIN and Socket, 2 Position In-Line Connectors

Dimensions shown are typical for all standard 2 position in-line connectors.

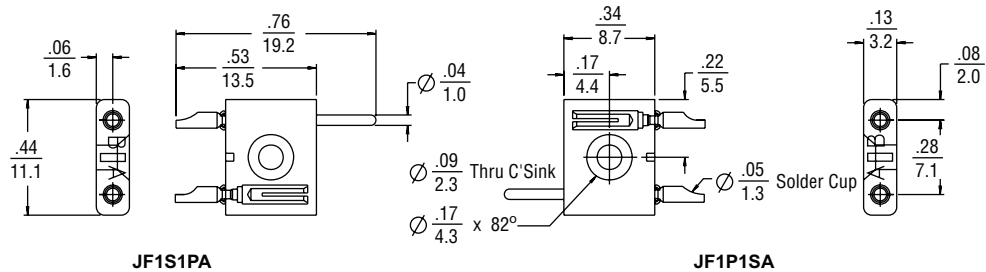

JF1S1PA

JF1P1SA

JF Series, PIN and Socket, 4 Position In-Line Connectors

Dimensions shown are typical for all standard 4 position in-line connectors.

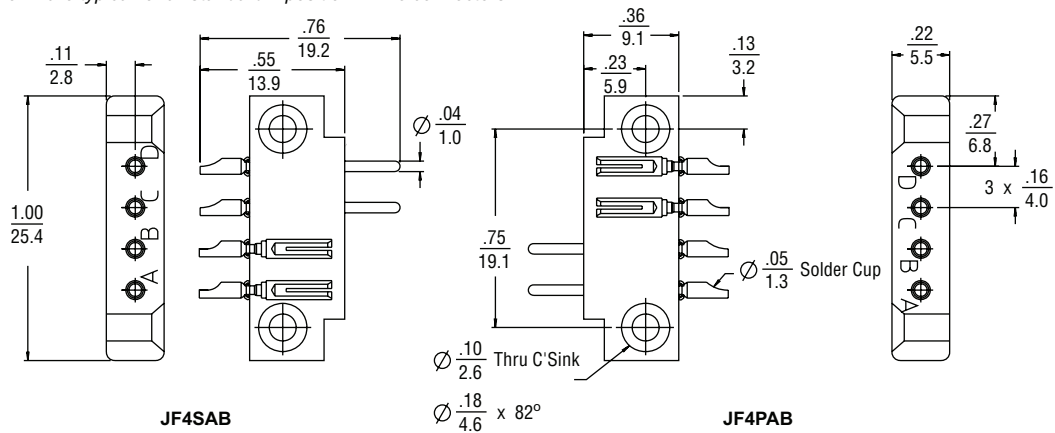

JF4SAB

JF4PAB

Side Mounting, 4 Position Rectangular, 2 and 4 Position In-Line

JF Series, PIN and Socket, 4 Position Rectangular Connectors

Dimensions shown are typical for all standard 4 position rectangular connectors.

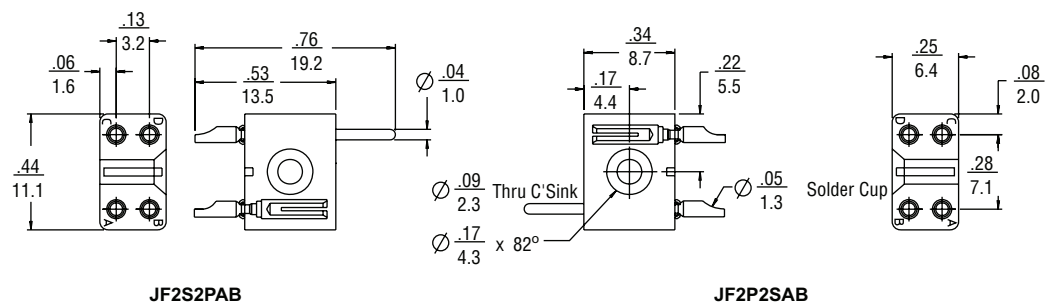

JF2S2PAB

JF2P2SAB

Winchester

62 Barnes Industrial Road North, Wallingford, Connecticut 06492 Phone:(203)741-5400 Fax:(203)741-5500 www.winchesterelectronics.com

Rack & Panel

JF Series

Miniature Side Mount / #20 Contacts / .040" Dia. / 7.5 Amps

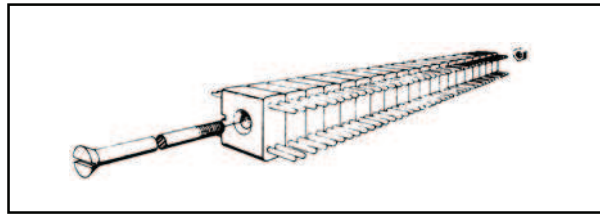

JF-2P
20 connectors assembled

The versatile JF Series has a countersunk mounting hole and narrow width permitting exceptionally flat mounting. Maximum circuit density is provided with many positive polarizations. "Custom" multi-contact connectors are readily available by using the building block technique shown above.

OUTLINE

Dimensions are for reference only and are subject to change. Outline drawings on request.

Typical Connector With DIP Solder Termination

JF Series connectors may be ordered with dip solder and right angle terminations. Consult factory for availability.

Straight Dip Solder

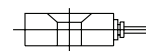

Right Angle Dip Solder

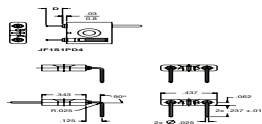
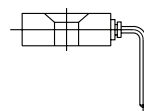

Typical Connectors Assemblies

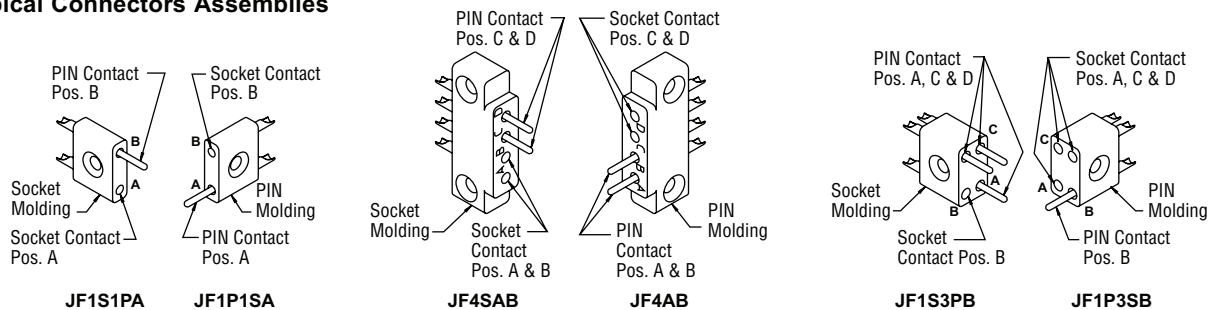

Winchester

62 Barnes Industrial Road North, Wallingford, Connecticut 06492 Phone:(203)741-5400 Fax:(203)741-5500 www.winchesterelectronics.com

ORDERING INFORMATION

2 Position In-Line Connector

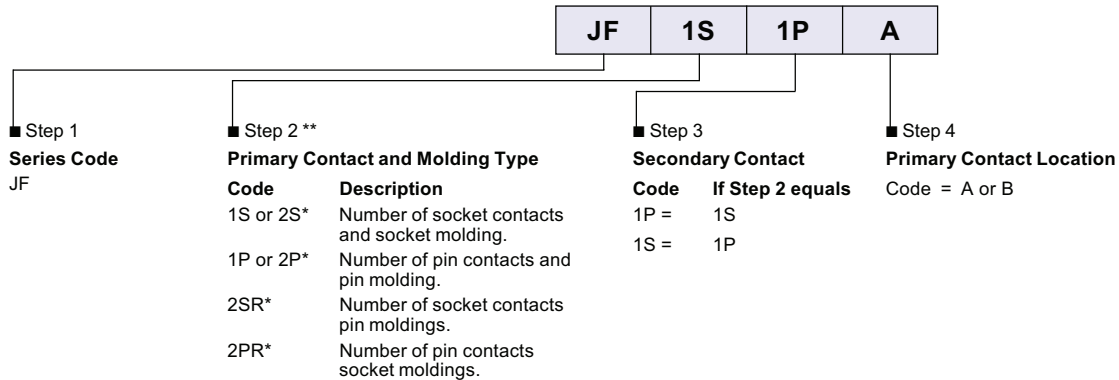

*For two same type contacts, skip Steps 3 & 4.

4 Position In-Line Connectors

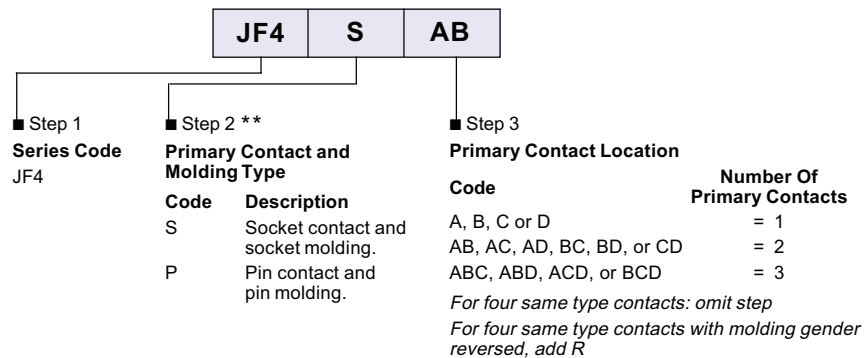

4 Position Rectangular Connector

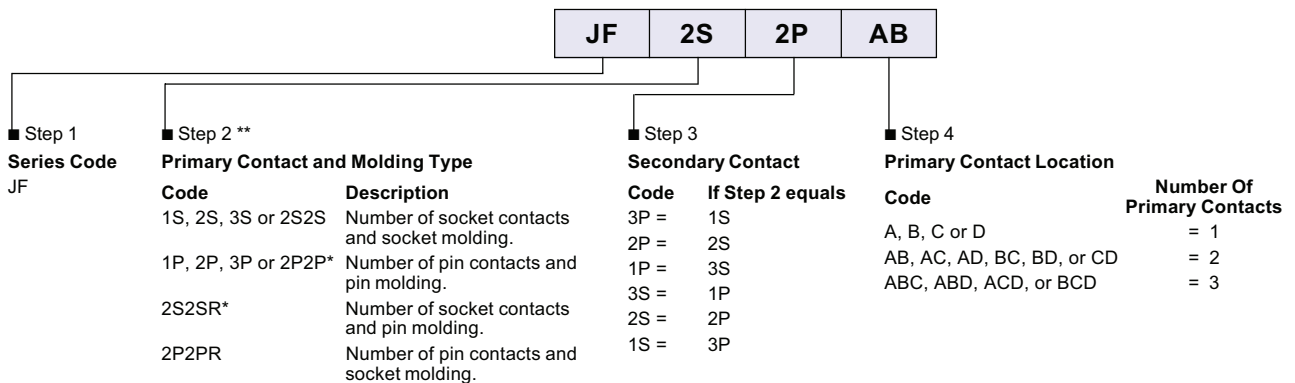

*For four same type contacts, skip Steps 3 & 4.

**For Pictorial Presentation, see RP/84 and RP/85

SPECIFICATIONS

Materials

Moldings (PIN and Socket): Diallyl Orthophthalate
Pin Contacts: .040 Brass, gold plated
Socket Contacts: Phosphor bronze, gold plated

Performance Characteristics

Dielectric Withstanding Voltage: 1500 VAC (at sea level)
Current Rating: 7.5 Amps
Operating Temperature Range: -55°C to +125°C
Termination Type: .050 dia. solder cup to accept #20 AWG stranded wire.

Winchester.

62 Barnes Industrial Road North, Wallingford, Connecticut 06492 Phone:(203)741-5400 Fax:(203)741-5500 www.winchesterelectronics.com